



Shanghai optics



METALLURGICAL BRIGHT FIELD OBJECTIVE LENS

METALLURGICAL BRIGHT FIELD 5X

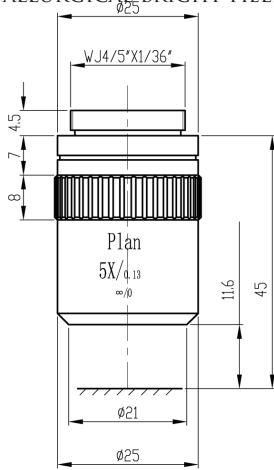

METALLURGICAL BRIGHT FIELD 10X

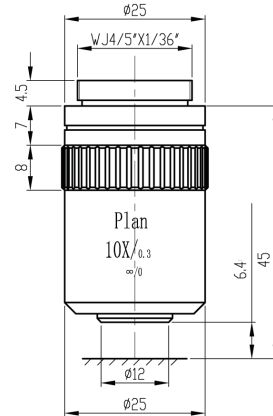

METALLURGICAL BRIGHT FIELD 20X

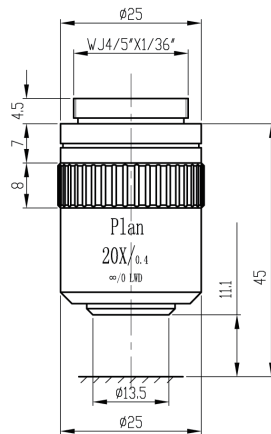

METALLURGICAL BRIGHT FIELD 50X

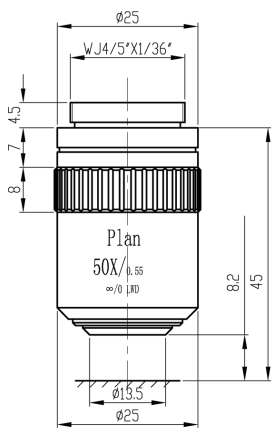

METALLURGICAL BRIGHT FIELD 100X

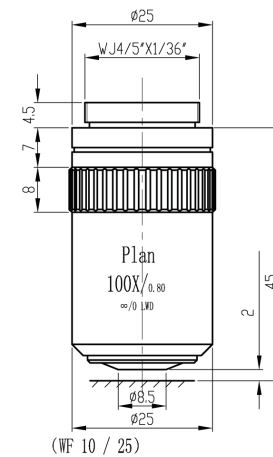

(WF 10 / 25)

OBJECTIVE LENS

	N.A.	W.D.	EFFL F'(MM)	RESOLUTION RATIO R(UM)	PHYSICAL DEPTH OF FOCUS ±ΔDELTA P(UM)	FIELD Ø 24 EYE	FIELD (1/2CCD)
METALLURGICAL BRIGHT FIELD 5X	0.13	11.6	40	2	38.25	Ø 5	0.96X1.28
METALLURGICAL BRIGHT FIELD 10X	0.12	4.80	18	1.1	4.4	Ø 2.5	0.48X0.64
METALLURGICAL BRIGHT FIELD 20X	0.45	2.89	9	0.6	1.4	Ø 1.25	0.24X0.32
METALLURGICAL BRIGHT FIELD 50X	0.65	0.55	4	0.4	0.7	Ø 0.5	0.10X0.13
METALLURGICAL BRIGHT FIELD 100X	0.85	0.503	3	0.3	0.4	Ø 0.25	0.05X0.06